

** THIS IS YOUR SPARE PARTS LIST. SAVE FOR FUTURE REFERENCE, ORDER BY PART NUMBER. CURRENT PRICES WILL BE QUOTED.**

SPARE PARTS LIST

QTY	ITEM NOTE	DESCRIPTION	ASSY/PART #
1	1	90° FRAME- RAIL MOUNT	510-001M
1	2	CYLINDER ASSEMBLY	510-108A
1	3	TRUNION- WIRE BORE	510-003M
1	4	TRUNION PIVOT PIN	530-026M
2	5	TRUNION RETAINING RING	1125F
1	6	CLEVIS PIN	150-012M
1	7	E CLIP	1039F
1	8	FRAME SPACER	530-021M
2	9	FRAME SCREW	1047F
1	10	SET SCREW	1198F
1	11	3/16" WIRE RH	608-003M
1	12	3/16" WIRE LH	608-004M

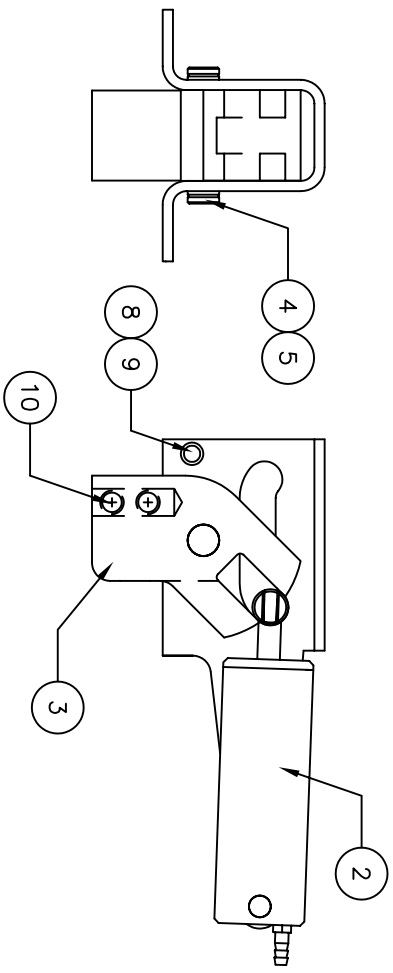
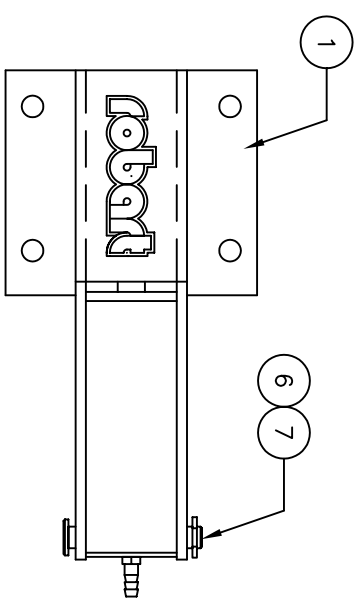

NOTE: GRIND FLAT ON END OF WIRE AS SHOWN
 TO PROVIDE PROPER SEATING OF SET SCREWS
 THIS WILL HELP WIRE FROM ROTATING IN TRUNION
 LOCATION OF FLAT WILL DETERMINE TOE IN / TOE OUT

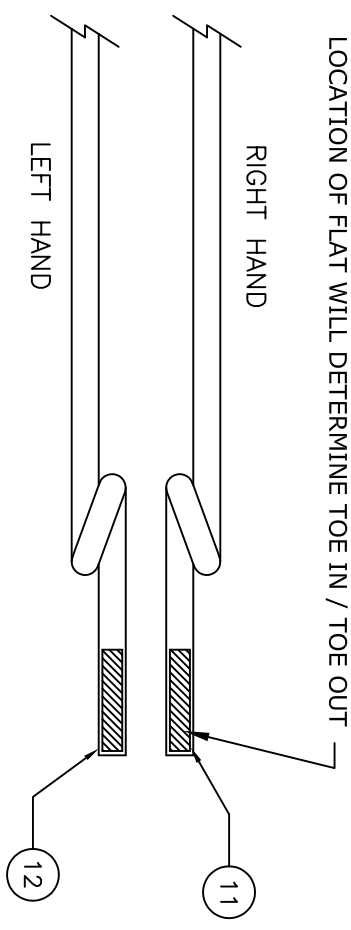

CHK'D BY			MFG. INC. 625 N. 12TH ST. ST. CHARLES, IL (630)584-7616
DRAWN BY	J. REHAK		
DATE	6/05	TITLE	510 90° WIRE MAIN GEAR RAIL MOUNT ECONOMY SPARE PARTS LIST
MODEL No.	510W1 512W1		

FACTORY REPAIR FEE= \$25.00 PLUS PARTS

906-248M