

** THIS IS YOUR SPARE PARTS LIST. SAVE FOR FUTURE REFERENCE, ORDER BY PART NUMBER. CURRENT PRICES WILL BE QUOTED.**

SPARE PARTS LIST

QTY	ITEM NOTE	DESCRIPTION	ASS'Y/PART #
1	1	105° FRAME - FIREWALL MOUNT	517-001M
1	2	CYLINDER ASSEMBLY	510-108A
1	3	TRUNION - NOSE WIRE BORE	510-004M
1	4	TRUNION PIVOT PIN	530-026M
2	5	TRUNION RETAINING RING	1125F
1	6	CLEVIS PIN	150-012M
1	7	E CLIP	1039F
1	8	FRAME SPACER	530-021M
2	9	FRAME SCREW	1047F
1	10	CLAMP SCREW	1048F
	11		
1	12	STEERING ARM ASSEMBLY	BF 4F-204A
1	13	#6-32 SET SCREW	1060F
1	14	NOSE GEAR WIRE	514-001M
1	15	WHEEL COLLAR	102-005P
1	16	SET SCREW	1142F
	17		

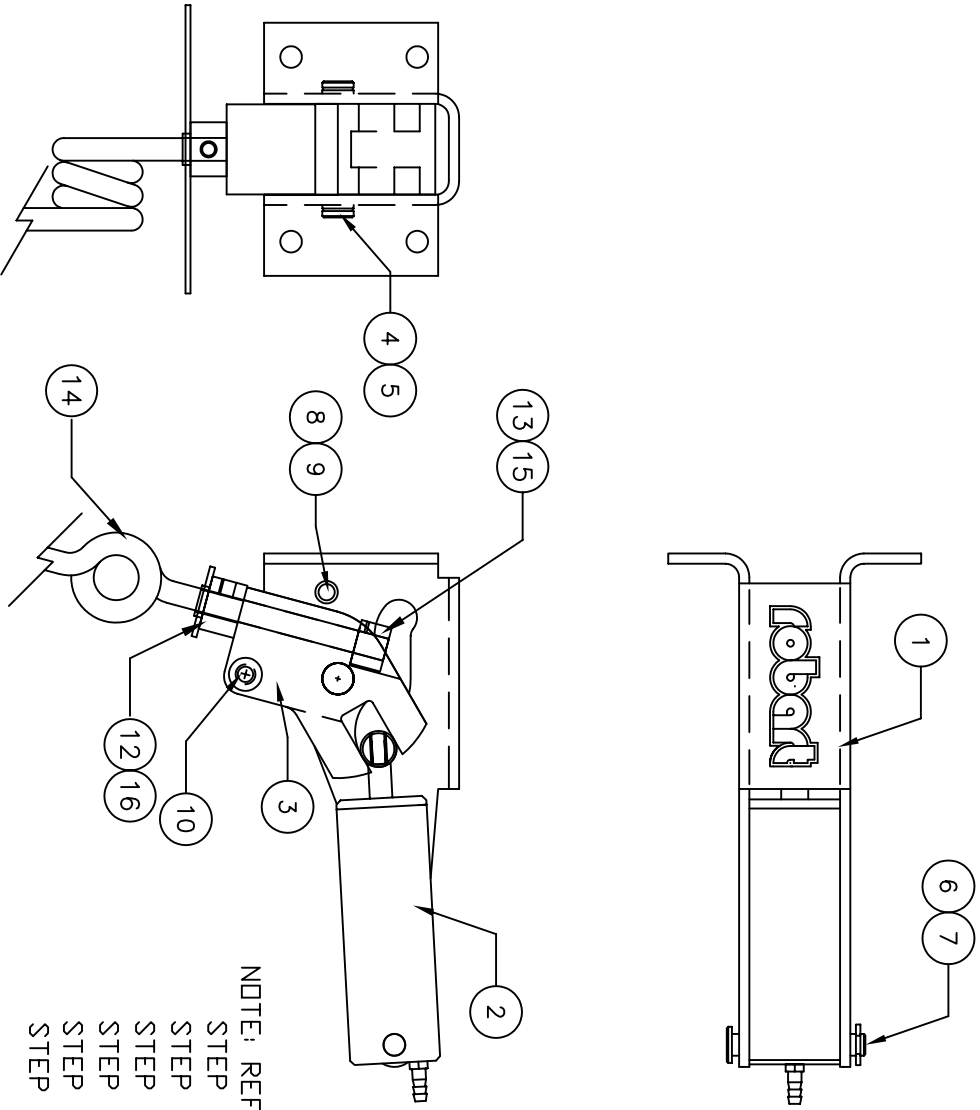

NOTE: REFERENCE DRAWING FOR WIRE AND STEERING ASSEMBLY

STEP 1 ASSEMBLE WIRE AND STEERING ARM WITH #15
 STEP 2 SLIDE WIRE INTO TRUNION AND CHECK CLEARANCE
 STEP 3 LOCK WHEEL COLLAR ONTO WIRE AND CHECK AGAIN
 STEP 4 DIS-ASSEMBLE AND GRIND FLATS ON SCREW MARKS
 STEP 5 RE-ASSEMBLE WITH THREAD LOCKER ON SCREWS
 STEP 6 CHECK FOR FREE MOVEMENT AND IF GEAR RETRACTS

CHK'D BY	
DRAWN BY	J. REHAK
DATE	6/05
MODEL No.	517W1
MFG. INC. 625 N. 12TH ST. ST. CHARLES, IL (630)584-7616 www.robot.com	
TITLE 517 105° WIRE NOSE GEAR FIREWALL MOUNT ECONOMY SPARE PARTS LIST	

906-252M

FACTORY REPAIR FEE= \$25.00 PLUS PARTS