

** THIS IS YOUR SPARE PARTS LIST. SAVE FOR FUTURE REFERENCE, ORDER BY PART NUMBER. CURRENT PRICES WILL BE QUOTED.**

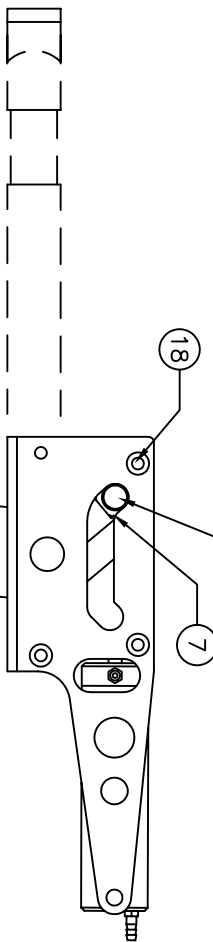

AXLE BAG ASSEMBLY FOR BONANZA
TRI-GEAR SET IS BNZ-142A
** INCLUDES ALL PARTS FOR NOSE
AND MAIN GEAR AXLE ASSEMBLY

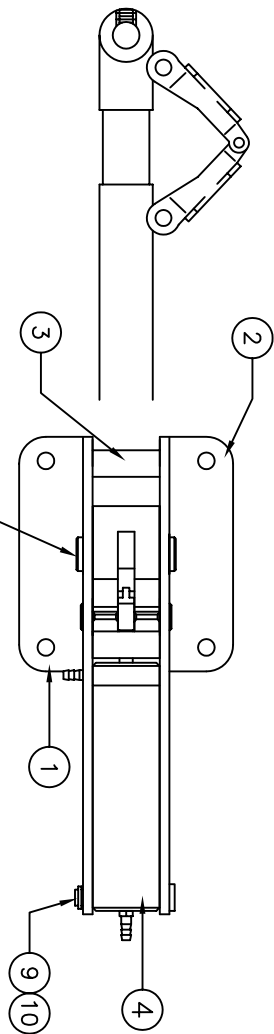

SPARE PARTS LIST

ITEM	DESCRIPTION	ASSY/PART #
1	SIDE FRAME (LH)	630-030M LH
2	SIDE FRAME (RH)	630-031M RH
3	FRAME SPACER	630-005M
4	CYLINDER ASSEMBLY	630-102A
5	TRUNION	630-003M
6	CAM PIN	630-012M
7	CAM FOLLOWER	630-011M
8	TRUNION BOLT	630-006M
9	CLEVIS PIN	150-012M
10	RETAINING RING	1039F
11	CLAMP SCREW	1110F
12	UPPER STRUT TUBE	BZA-103A
13	OLED STRUT	BZA-104A
14	SPRING 5' LONG	150-019P
15	TORQUE LINK ASSEMBLY	620-112A
16	CLEVIS PIN	620-012M
17	AXLE	145-133M
18	#4-40 x 1/4" PPHMS	1047F
19	TRUNION PIN **	630-333M
20	PIN RETAINING RING **	1132F

** USED FOR NEW STYLE
NOTE WHICH STYLE WHEN ORDERING

CHK'D BY		MFG. INC.
DRAWN BY	J. REHAK	625 N. 12TH ST. ST. CHARLES, IL (630)584-7616
DATE	6-14-02	
MODEL No.	630BNZ	
FACTORY REPAIR FEE= \$25.00 PLUS PARTS		
www.robart.com		
TITLE		BONANZA RH SHOWN

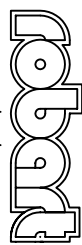

906-058M